



COTERIE  
CATHEDRAL HILL

1001 Van Ness Avenue, San Francisco  
415.915.6655 | LiveCoterie.com

# STUDIO COTERIE MEMORY CARE



COTERIE  
CATHEDRAL HILL

\*Any additional resident, including private aides, will be charged the second person fee.  
Measurements are an approximation and can vary by residence. Rate is subject to change.

License #385601116

# STUDIO

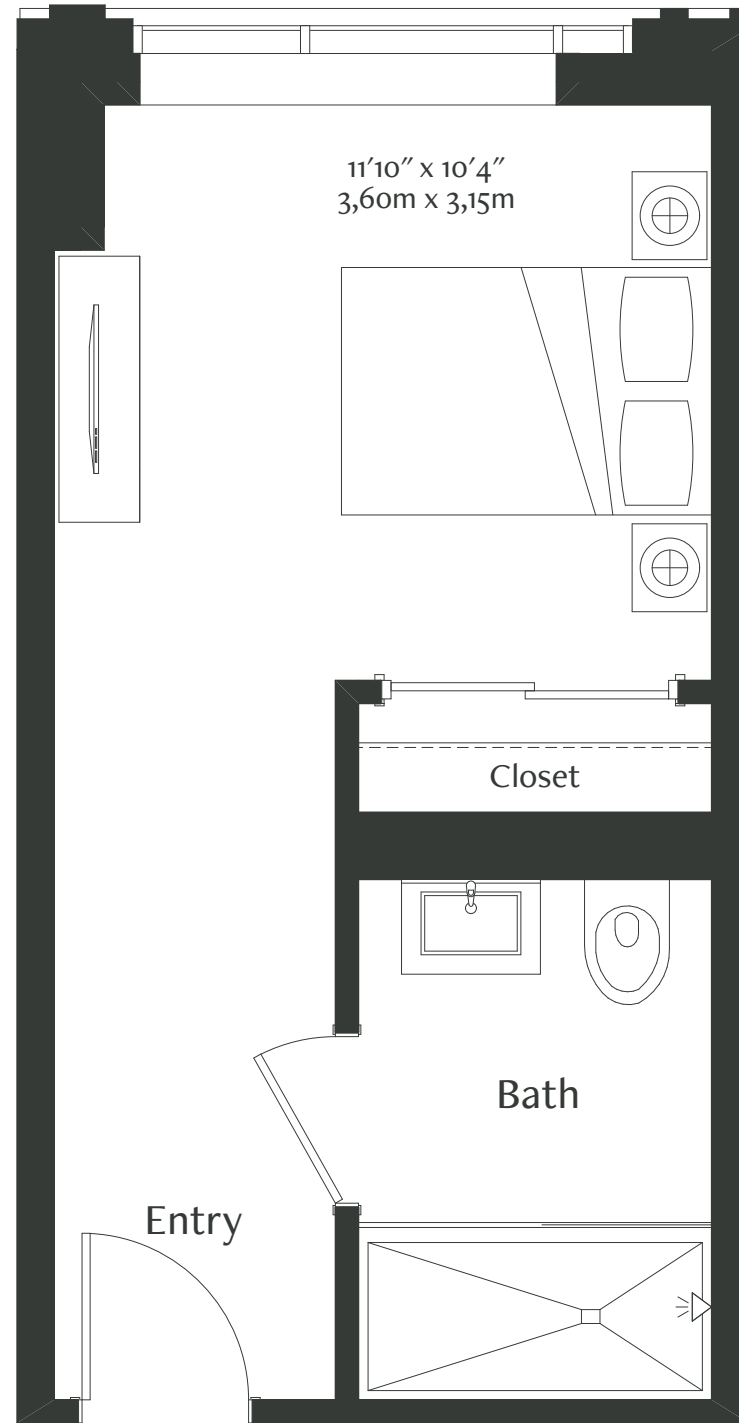

## RENTAL RATE INCLUDES

- Three chef-prepared meals daily
- Daily curated social, cultural, and fitness offerings
- Wearable emergency alert system technology
- Individual care plan with 24/7 support
- Assistance with bathing, grooming, and toileting from staff with specialized and ongoing dementia training
- Medication assistance provided by technicians under the supervision of a licensed nurse
- Housekeeping, personal laundry, and linen services
- Assistance getting out of a bed or chair, escorts to and from meals and events
- Escorts to and from meals and events

## RESIDENCE FEATURES

- Herringbone hardwood flooring with custom inset carpet
- Marble bathrooms with walk-in showers
- Custom cabinetry, millwork, and quartz countertops
- Coterie Smart Home System, which includes smart television, lighting, and thermostat, and automated shades

---

MONTHLY RESIDENCE RATE \_\_\_\_\_

COMMUNITY FEE \_\_\_\_\_

SECOND PERSON FEE\* \_\_\_\_\_

RESIDENCE NUMBER \_\_\_\_\_

SQUARE FOOTAGE \_\_\_\_\_

FLOOR NUMBER \_\_\_\_\_

---

SALES DIRECTOR \_\_\_\_\_

DATE \_\_\_\_\_

RATE GOOD UNTIL \_\_\_\_\_