

Jasmine And Daffodil - Two Bedroom

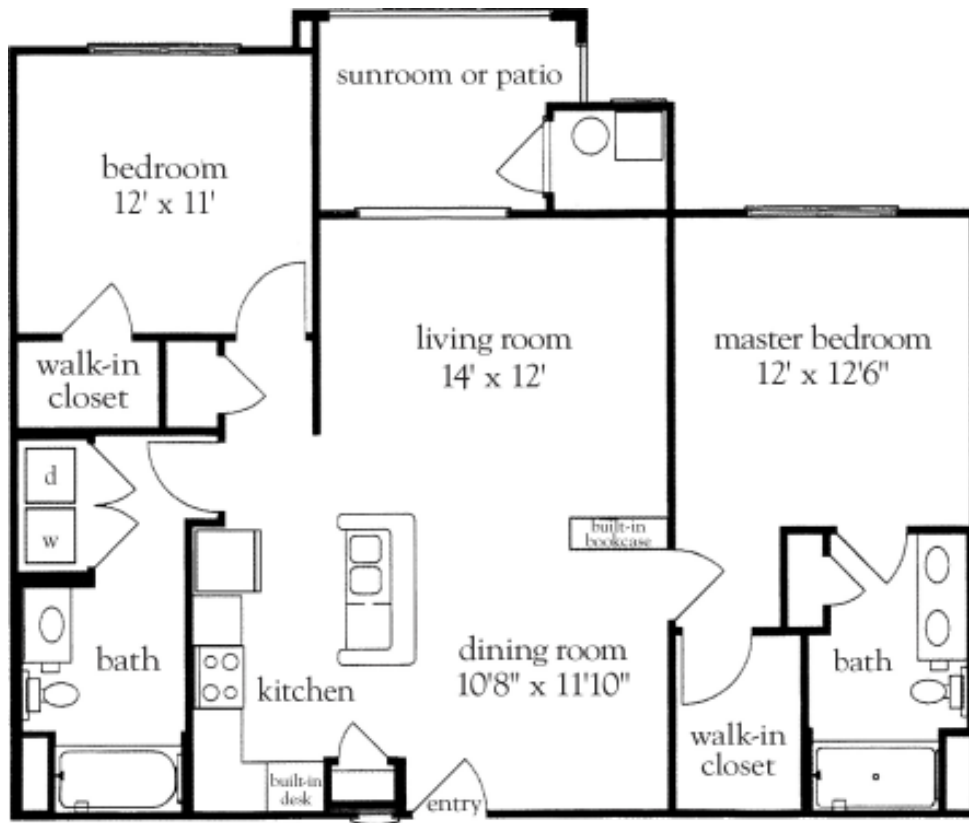

Apartment No. _____ Square Footage _____ Apartment Rate _____

Notes _____

Date Quoted _____ Quoted by _____ Rate Expires _____

Atria SOUTHPOINT WALK

919.401.0100 | AtriaSouthpointWalk.com

Measurements are an approximation and can vary by apartment.
All rates are subject to change.
HAL-032-131

Rental Rate includes

- 24-hour staff
- Two chef-prepared meals per day
- Daily educational, social, cultural and fitness opportunities
- Housekeeping and linen services
- Scheduled bus and sedan transportation
- Utilities
- Wi-Fi in all common areas
- In-apartment washer and dryer hookups - selected apartments
- Apartment maintenance